

Office for rent in Paitilla, PH Pacific Center, 1,260m2

Descripción



Location: Ramón H. Jurado Street, Paitilla Boulevard, San Francisco

Building: Pacific Center

Footage: 1,260m2

Property Description:

- Work in gray
- Full floor
- Electrical system
- Maintenance fee \$5.00
- 5 year contract
- 25 parking lot stickers

Building Description:

- Pacific Center is a mixed-use complex, measuring more than 200,000m2 and with 2,000 parking spaces; that meets the needs of its users in a simple and efficient way, by having a hospital, commercial area, cultural center, hotel, medical and administrative offices, all under one roof.
- An Office Tower.
- Boutique mall style commercial area.
- This Boutique mall area houses commercial premises such as restaurants, cinemas, banks, supermarkets, gym, theatre, entertainment for children, cultural events, laundry, beauty salon, optician, pharmacies, etc.
- And a Hotel Tower with the highest quality standards.
- Pacific Center has LEED certification, guaranteeing designs and finishes.

Rental price: \$22,680.00 + ITBMS

Price per m2: \$18.00

ID de Propiedad	OPANZ22.4.24.1
Área de Terreno	mt ²
Área de Construcción	1260 mt ²
Precio	22,680.00
Precio por Área	18.00
Baños	11
Estacionamientos	25

Ubicación

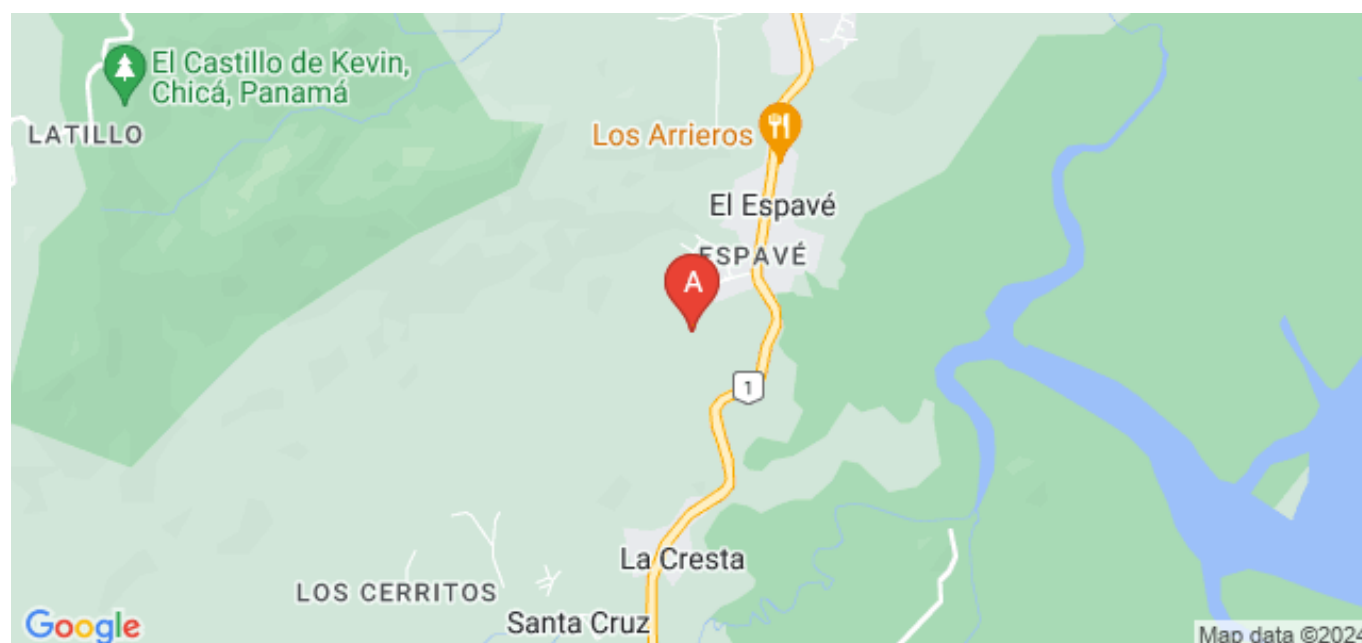

Agente



Zuleyma Montenegro

[+50768184534 \(Llamar\)](tel:+50768184534)

[+50768184534 \(WhatsApp\)](tel:+50768184534)

info@imperial.com.pa

+50768184534

+50766150060



Fotos



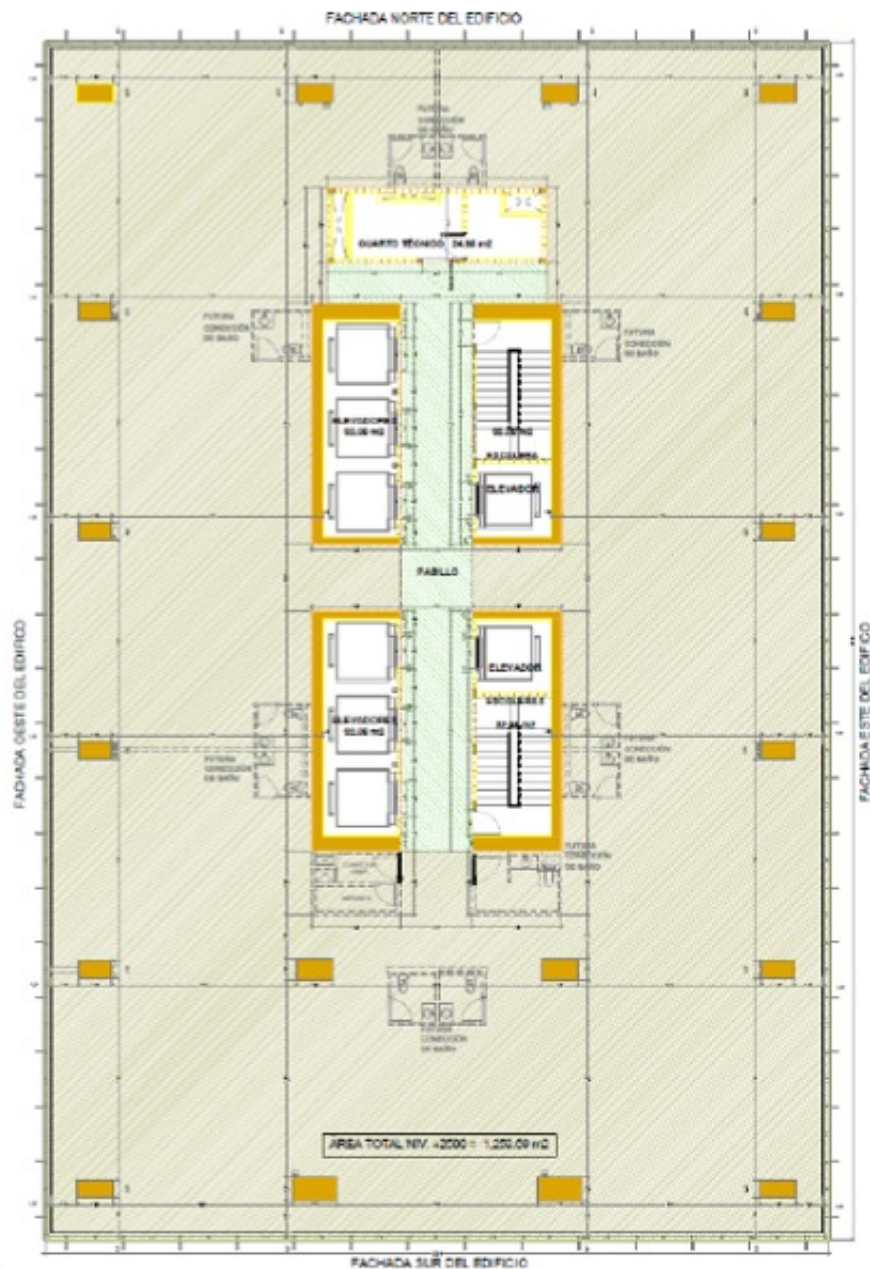

*Eti
em
por
SIN ESCALA
contrato separado y específico que refleje los términos mutuamente acordados.

PLANTA ARQUITECTÓNICA - OFICINAS TORRE A - NIVEL +2500
NIVEL 34 (RIS. PÚBLICO)



